





**\*\*AVAILABLE JANUARY 2026\*\***  
**\*\*FURNISHED\*\* \*\*SPACIOUS UPPER**  
**MAISONETTE WITH REAR TERRACE\*\*** A

stylish and quirky upper Tyneside maisonette ideally placed on Fairfield Road in West Jesmond. Boasting spacious rooms throughout, period features, private outside space and located conveniently within walking distance to an abundance of shops, bars & cafes as well as West Jesmond Metro station.

The accommodation briefly comprises; entrance hall with staircase to the first floor; bedroom two to the front, with bay window and feature fireplace; separate study which could also double as a guest bedroom if preferred; large lounge measuring 18ft with feature fireplace, sliding sash windows and built in book case with door leading to a separate WC; to the rear off-shoot there is a traditional style kitchen, with vaulted ceiling, appliances, wood flooring and double doors leading out on to a private sun deck, with stairs access down to rear service lane; 2nd floor comprises a family bathroom WC, including a roll top bath & separate walk in shower; master bedroom, an 18ft double with exposed beams and dormer extending balcony window. Externally to the front there is on street permit parking. To the rear, a pleasant outlook over Jesmond Community Orchard Cemetery.

Please Note: this property can only be let to either a single family household or maximum of two individual sharers.

Available January 2026 | £1,500pcm | Furnished | Upper Tyneside Maisonette | 1,149 sq ft (106.8m<sup>2</sup>) | Two Large Double Bedrooms | Study/ Additional Guest Bedroom | 18ft Lounge | Separate WC | Kitchen | 2nd Floor Bathroom WC | South Facing Sun Deck | Great Location | On Street Permit Parking | Period Features | GCH & Part DG | Council Tax Band: B | EPC Rating: D

**£1,500 PCM**

**IMPORTANT NOTE:** These particulars and the descriptions and measurements herein do not constitute representation and whilst every effort has been made to ensure accuracy, this cannot be guaranteed.

GROUND FLOOR  
46'6" x 12'4" (approx.)

FIRST FLOOR  
72'6" x 10'4" (approx.)

2ND FLOOR  
57'6" x 10'4" (approx.)

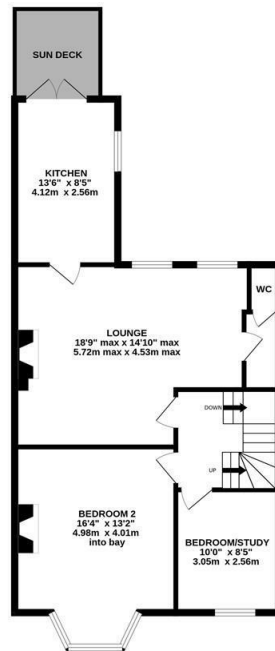
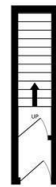

TOTAL FLOOR AREA: 1149 sq.ft. (106.8 sq.m.) approx.  
 While every attempt has been made to ensure the accuracy of the floorplan contained here, measurements of doors, windows, rooms and any other items are approximate and no responsibility is taken for any error, omission or mis-statement. This plan is for illustrative purposes only and should be used as such by any prospective purchaser. The services, systems and appliances shown have not been tested and no guarantee as to their operability or efficiency can be given.  
 Made with Metropix G2025

